



WEB BASED APPLICATION SPECIFIC INSTALLATION INSTRUCTIONS



Replacing Combination Windows

Although all possible measures have been taken to insure the accuracy of the material presented, WIXSYS, and the author are not liable and do not assume any liability in case of misinterpretation of directions, misapplication, improper installation, or typographical error.

Replacing Combination Windows

Frame In Replacement

A very common window configuration is the Picture Window flanked by two Double Hung Windows. Usually in the Living Room, these windows are a single unit of individual wood windows attached together and placed in a single opening in the wall.

The most common method of replacing these windows is to treat them the same as single windows and remove the operating sash of the Double-Hungs and the single Picture Window which will leave an opening with stops against which the new replacement pocket window can be placed.

The old window sashes are removed to the outside leaving the interior stops and trim intact. Exactly as would be done in an "Outside-In" install, the new windows are put out through the opening and brought back against the interior stops.

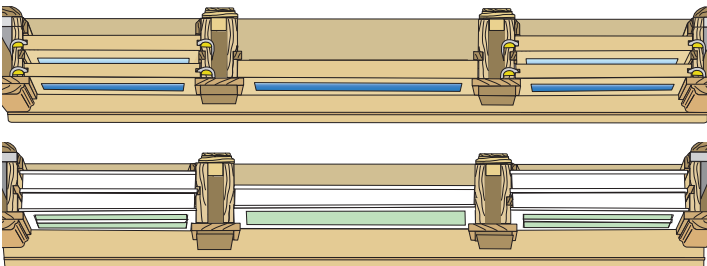
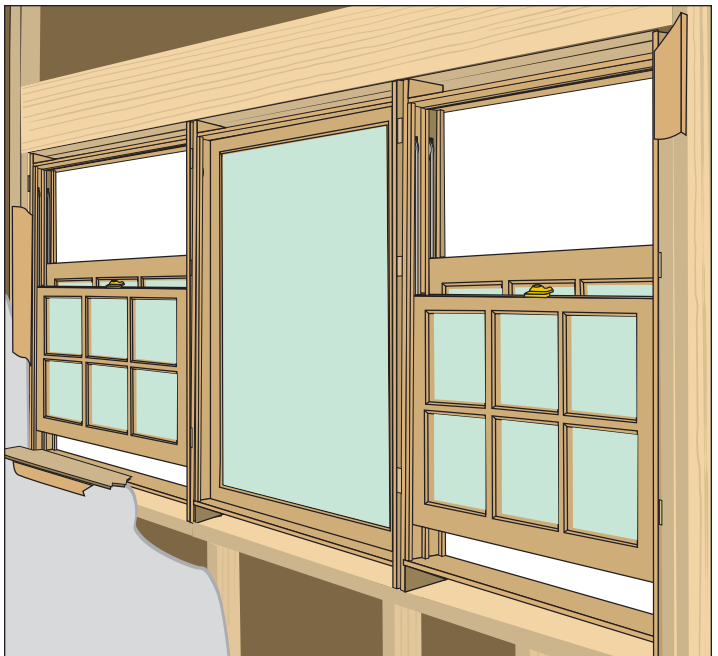

Frame Out Replacement

Because most combination windows were installed as a single window unit, the header and rough opening can be cleared out and a new window assembly can be installed.

The options are many: You can install a Bay or Bow Window, or a group of Casement Windows or a group of two Double Hung windows flanking a Picture Window with a Mull between each window.

The design choice is endless.

Make sure the opening is properly flashed and a suitable sill pan drainage is installed using adhesive backed flashing or a pre-made sill pan.

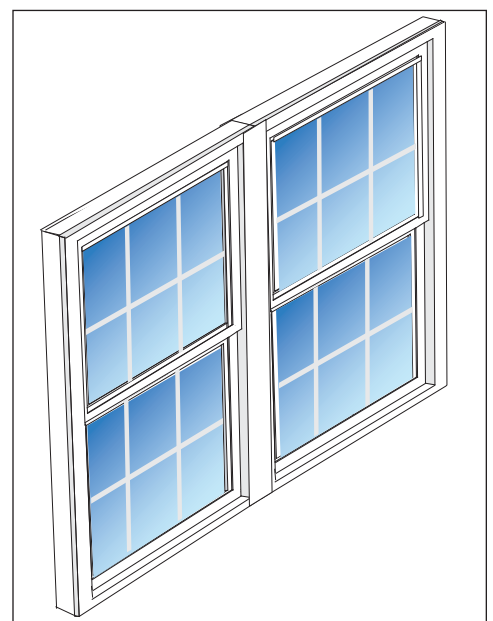
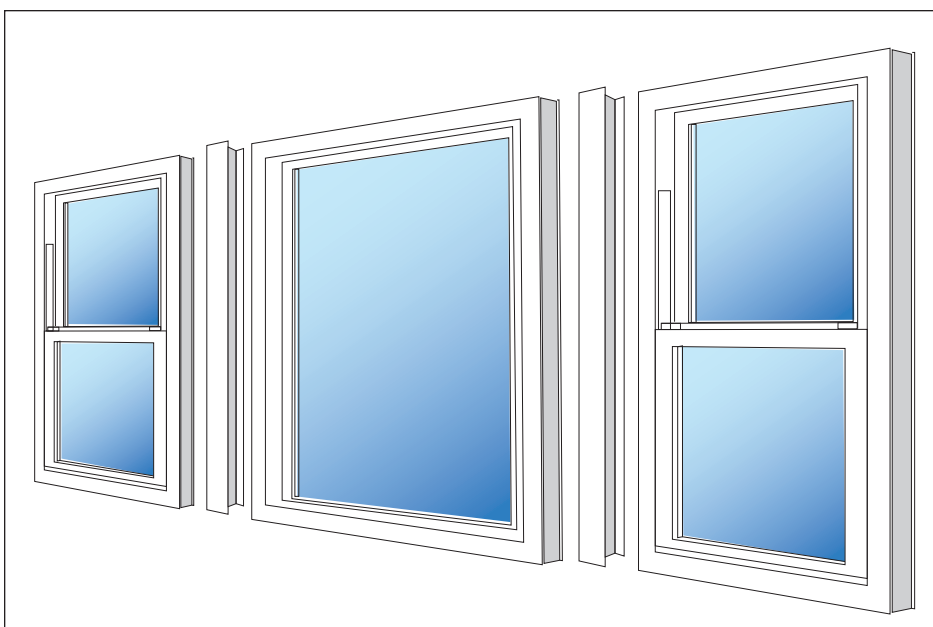
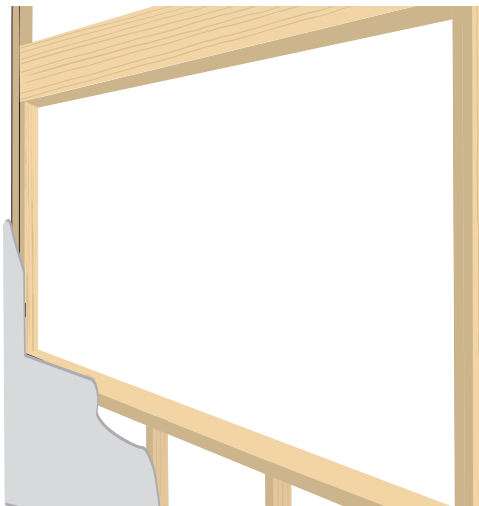

Picking the Proper Sealant

AWDI understands that the application of a sealant is as crucial as the choice of sealant. When a bead of sealant is applied to a joint there are severable factors to consider:

- Adhesion
- Flexibility
- Durability
- Compatibility
- Temp, Weather, Exposure)
- Aesthetics

Within these three performance aspects there are countless combinations of applications, substrates and conditions a sealant is exposed to.

Bedding Joints:

For bedding joints, it is especially important that the sealant meet AAMA 800-802, and is of the right consistency and made up of 100% solids so it will not shrink after cure, unlike solvent and latex based sealants that shrink and create gaps after curing.

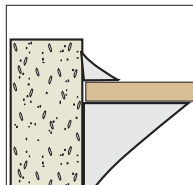

Fillet Joints:

A fillet joint is formed when two surfaces come together to form a right angle. The sealant used to join these two surfaces is triangular in shape. The sealant must adhere to the variety of substrates you're faced with. Without strong adhesion there is a high chance that the sealant will pull away from the substrate allowing for air and water infiltration.

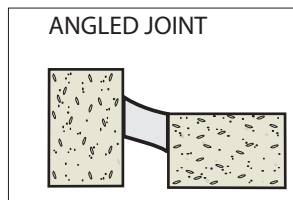
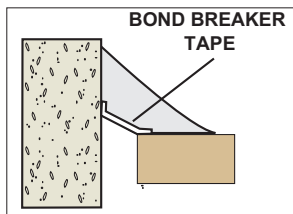

Control Joints:

A control joint is formed when two similar or dissimilar materials meet or when substrates do not form a right angle. This joint will require both a backer rod and sealant for proper application. This joint can be as wide as 5/8 inch and be prone to extreme movement, a highly flexible sealant is necessary for a reliable seal with this application. In order to successfully install a window or door and effect a lasting weathertight seal, AWDI recommends an ASTM C920, Class 50 sealant such as premium

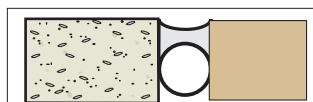
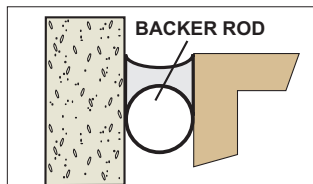

DYNAFLEX® from DAP as a good representative to seal the exterior joints of windows and exterior finish materials. The best choice is a sealant that meets AAMA 800-802 to assure proper adhesion to the most common building materials and that is compatible with WRB and flashing tapes; and can be used in a wide temperature range and wet surfaces.



Desired Properties

- No Shrinkage
- Locks out air and water infiltration to protect integrity of the seal
- Proven Wet Surface Application
- Ability to use the same sealant in warm and cold temperature situations to produce consistent results. 0F – 140F cold and warm weather application
- Strong Adhesion / All Surfaces Will stick to even the most difficult to bond building materials
- 5X stretch, 50% joint movement Long term durability assurance even with expansion and contraction of building materials
- 24 hour fast cure, paintable 1 HR. Fast cure to protect the building structure from outside forces and quick paintability saves time
- Achieves bubbling resistance faster to ensure optimal aesthetics
- 4,600 + Color Matches ensures perfect color match to all primary building materials
- Dirt & Dust Resistance ensures optimal visual appeal long after an installation
- UV Resistance
- Long term durability to compliment the durability of the building structure

Spray Foam Insulation

While the term “Spray Foam” is often widely used in construction, there are two different types and each has its advantages and disadvantage.

Spray foam has been shunned by window installers and manufacturers over the years because foams, in the past, have either continued to expand after trim has been applied deforming the more pliable vinyl window frames, or because they have been over used to fill the gaps left when old windows are removed and the underlying rough opening has been exposed.

Make sure the foam you use has been tested in accordance with AAMA 812 and meets standard for low pressure development.

Most standards applying to window installation do not delineate between open cell foam and closed cell foam, the more popular “minimal expansion” foams are most frequently used and they are mostly closed cell. More confusing yet, is when foams are recommended, the compressed foam tape alternatives are called out to be open cell.

When it comes to Spray Foams, it helps to understand the differences. Open-cell spray foam (ocSPF) has a cell structure where the cells are filled with air. The open-cell structure renders soft, flexible foam, with a density of about 0.5-0.8 pounds per cubic foot (pcf).

The R-value per inch of open-cell foam typically ranges from R3.6 to R4.5 per inch. Unlike fiberglass and cellulose, the fine cell structure of ocSPF makes it air-impermeable at certain thicknesses. The air-impermeability of ocSPF qualifies it as an air-barrier material, dramatically reducing air leakage through the building envelope, significantly lowering the building’s heating and cooling costs. However, ocSPF, like fiberglass and cellulose insulations, is moisture-permeable, and may require the installation of a vapor retarder in colder climates.

Closed-cell spray foam (ccSPF) has a closed cell structure which yields rigid hard foam, with a



density of 1.8-2.3 pound per cubic foot (pcf), and can provide structural enhancement in certain framed buildings. The smaller cells trap insulating gas from the curing, which has a lower thermal conductivity than still air, and increases the R-value to anywhere from R5.8 to R6.9 per inch.

Like ocSPF, ccSPF is also air impermeable at certain thicknesses and can qualify as an air-barrier material. The bigger benefit is that the closed-cell structure of ccSPF also makes it water-resistant, and is the only spray foam that can be used where contact with water is likely.

At a thickness of 1.5 inches, no additional vapor retarder is required for most applications.

Desired Properties

- Make sure the foam used has been tested in accordance with AAMA 812 and meets standard for low pressure development.
- Quick Setting Formulation: can be cut or trimmed in less than 1 hour
- Cold Temperature Application: can be applied in temperatures as low as 14F
- Insulation Value of R5: makes it an efficient method for stopping air and moisture infiltration
- Remains Flexible Once Cured: will not crack or dry out

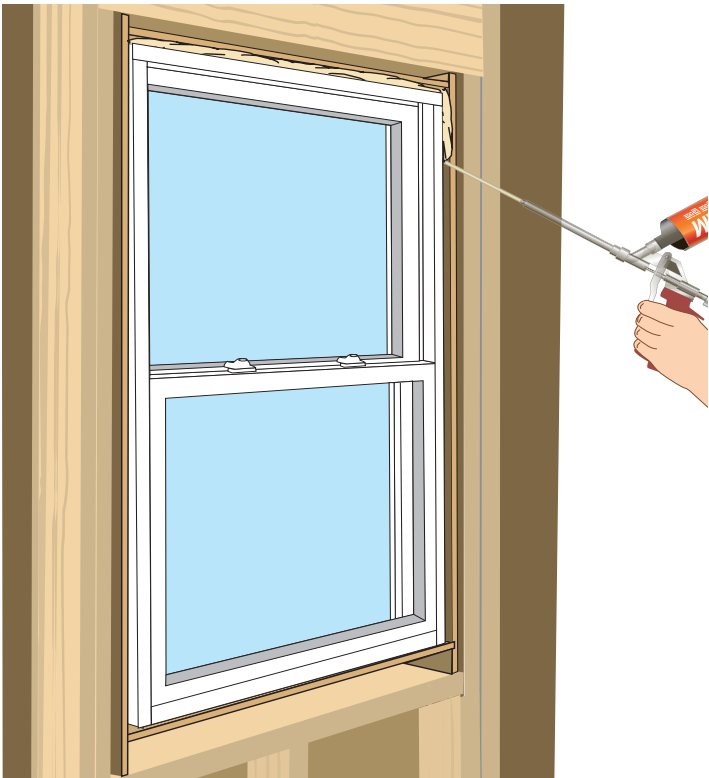

Important tips:

- Similar to the sealant gun, it is critical that you balance the movement of the foam gun or straw barrel and how you dispense the foam so that the foam makes contact with both the rough or existing window frame and replacement window frame.
- If the dispensed foam does not make contact with both the rough frame and the window frame, there won't be an adequate bond to seal out water and air.
- Industry Standards suggest application of 1 inch beads, separated by an equal space. Be careful not to create two vapor barriers - one at the exterior and one at the interior. Make sure there is the ability for the opening to breathe to the cold side for drying and drainage. Use backer rod about one inch in the sill as a stop to make a workable back dam
- When applying foam around the perimeter of the window or door, you must maintain a minimum depth of 1 inch. This depth is required to provide the correct thermal performance, to help improve energy savings, and to protect against condensation problems.
- When applying foam as a back dam to the gap between the window frame and the rough sill, do not allow the foam to extend to the exterior edge of the opening. Maintain a minimum of a 1 inch gap between the foam and the exterior edge of the rough sill. If foam fills this gap at the sill, any water from leakage will not be able to drain to the drainage plane or exterior cladding surface. Place backer rod the length of the sill, 1" from edge and use it as a back dam guide.

Using Spray Foam

For the best installation, it is necessary for the gap around the window or door to be sealed to block out air, water and vapor penetration. ccSPF can do that well if selected and used properly. Improper use can create water traps, impede drainage and exert excessive pressure to the window frame during expansion.

Remember: Vapor barriers need to be applied on the warm side of the opening. Double vapor barriers (one on the warm side and another on the cool side) encourage condensation between and will trap the resulting condensation. Also, window installation cavities (the space between the window frame and the rough opening, or left-in-place old window frame) need to "breathe" to the outside, and allow drainage of collected water to the outside.

Used wisely, ccSPF can be the best solution. AWDI recommends DAP® DRAFTSTOP 812 Window and Door foam. DAP® DRAFTSTOP 812 also achieves a thermal performance of R-5 per inch.

Application

DAP DRAFTSTOP Foam is applied using a Foam Applicator Gun. This foam and gun combination allows for more precise application than the straw grade foam alternative. This gun offers a rear valve used to control the size of bead applied into the openings. The valve also allows the life of the foam to be extended by closing the opening of the barrel for future use.

For even smaller openings, a detachable screw on top is included with the gun to be able to fill gaps as small as ¼" wide.

